

DESCRIPTION

- Metal construction with various finish identified by suffix
- G1/2 inlet connections
- Thermostatic valve design
- Accessories are various by model. See the table below for details

OPERATION

- Knob Style handle
- Temperature handle operates through a 237° arc with maximum cold at full clockwise rotation and maxium hot at full counterclockwise rotation.
- Safety stop preset temperature at 38℃
- Factory established temperature range from 15℃ to 49℃

FLOW

- Water flowrate at 0.1Mpa is 6.0L/min minimum in tub spout, about 4.0 L/min to 9.0 L/min with hose and handheld shower.

CARTRIDGE

- Thermostatic cartridge design with Nonmetallic/ non-ferrous meterial

STANDARDS

- Designed to meet QB/T 2806 standard

WARRANTY

- 5 years limited warranty against leaks and drips

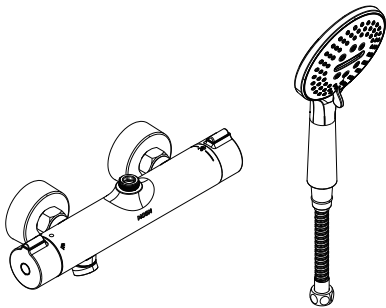

(Optional)

STEROPE
Thermostatic Tub Shower Faucet

MODELS : 57400 Series

SKU	Handheld Shower	Function	Hose (1500mm)
57400BL	B	3F	√
57400M	N/A	N/A	√
57400MCL01	A	3F	√
57400MCL02	A	3F	√

CRITICAL DIMENSIONS DO NOT SCALE

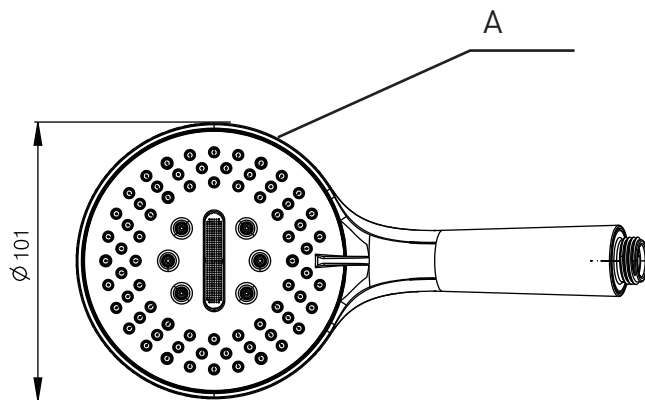
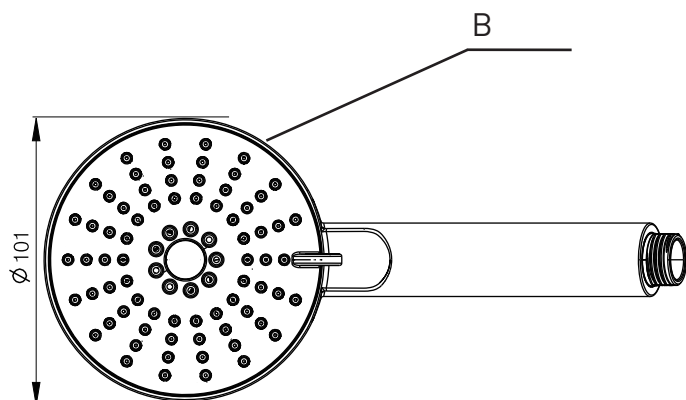
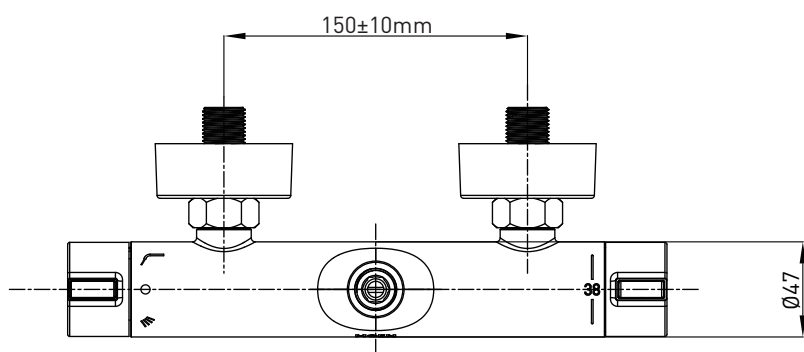
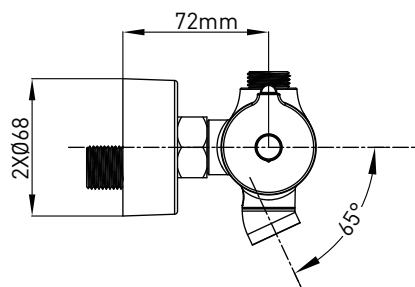
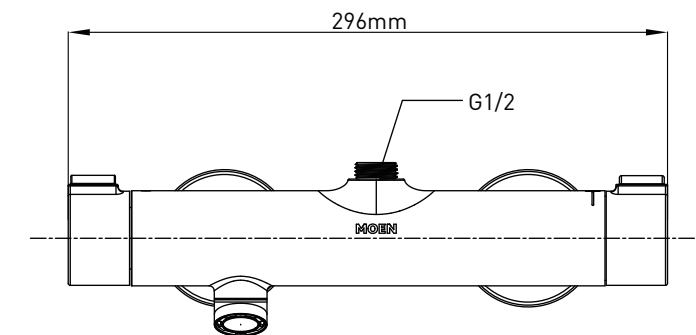

CRITICAL DIMENSIONS DO NOT SCALE